

NOTICE!!

These documents have been scanned!

Do not place un-scanned documents beneath this notice!

Do not remove this notice from this file!

GPO Jacket No. 560-102
Print Order 61540
Rise Business Services, LLC
Job=AZ15 6/24/2019



Box Number= AZ15129



Claim Begin-End: AMC427442-AMC427442

1 Initial Receipt



AZ15129-12

AMC364820-AMC427442

AMC#

DATE CLOSED

REMARKS

| AMC# | DATE CLOSED | REMARKS |
|--------|-------------|---------|
| 427442 | | |
| | | |
| | | |
| | | |
| | | |
| | | |
| | | |
| | | |
| | | |
| | | |
| | | |
| | | |
| | | |
| | | |
| | | |
| | | |
| | | |
| | | |
| | | |
| | | |
| | | |
| | | |

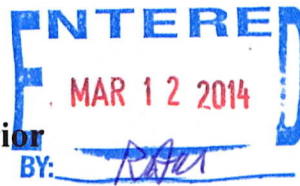

United States Department of the Interior
Bureau of Land Management
 LANDS/RECREATION & PLANNING
 ONE N CENTRAL AVE
 PHOENIX, AZ 85004 -2203
 Phone: 602-417-9200

Receipt

No: 2981470

| | |
|---|--|
| Transaction #: 3070277 | |
| Date of Transaction: 03/04/2014 | |
| CUSTOMER: | |
| JIMMIE COPE 3716 W MONONA DR GLENDALE, AZ 85308-2128 US | |

| LINE # | QTY | DESCRIPTION | REMARKS | UNIT PRICE | TOTAL |
|---------------|------|---|---------|------------|-----------------|
| 1 | 1.00 | LOCATABLE MINERALS / MINING CLAIMS-NEW, UNADJUD, ONE OR MORE AUTH NOS / NEW MINING CLAIM LOCATION FEE \$34 CASES: AMC427442/\$34.00 | | - n/a - | 34.00 |
| 2 | 1.00 | LOCATABLE MINERALS / MINING CLAIMS-NEW, UNADJUD, ONE OR MORE AUTH NOS / NEW MINING CLAIM PROCESSING FEE CASES: AMC427442/\$20.00 | | - n/a - | 20.00 |
| 3 | 1.00 | LOCATABLE MINERALS / MINING CLAIMS-NEW, UNADJUD, ONE OR MORE AUTH NOS / NEW MINING CLAIM MAINT FEE \$140 CASES: AMC427442/\$140.00 | | - n/a - | 140.00 |
| TOTAL: | | | | | \$194.00 |

| PAYMENT INFORMATION | | | |
|---|---------------|---|----------------------|
| NOTE: Items will appear on credit card statement as "Bureau of Land Mgmt CO". | | | |
| 1 | AMOUNT: | 194.00 | POSTMARKED: N/A |
| | TYPE: | CREDIT CARD | RECEIVED: 03/04/2014 |
| | NAME: | COPE, JIMMIE 3716 W MONONA DR GLENDALE AZ 85308-2128 US | |
| | CARD NO: | XXXXXXXXXXXX1564 | AUTH CODE: 001711 |
| | NAME ON CARD: | JIMMIE L COPE | |
| | EXPIRES: | 02/2017 | |
| | SIGNATURE: | | |

| |
|---------|
| REMARKS |
| |

This receipt was generated by the automated BLM Collections and Billing System and is a paper representation of a portion of the official electronic record contained therein.

NOTICE!!

These documents have been scanned!

Do not place un-scanned documents beneath this notice!

Do not remove this notice from this file!

GPO Jacket No. 560-102
Print Order 61540
Rise Business Services, LLC
Job=AZ15 6/24/2019



Box Number= AZ15129



Claim Begin-End: AMC427442-AMC427442

2 Correspondence



AZ15129-12

AMC364820-AMC427442

**NO
DOCUMENTS
FOUND**

NO DOCUMENTS FOUND
NO DOCUMENTS FOUND

NOTICE!!

These documents have been scanned!

Do not place un-scanned documents beneath this notice!

Do not remove this notice from this file!

GPO Jacket No. 560-102
Print Order 61540
Rise Business Services, LLC
Job=AZ15 6/24/2019



Box Number= AZ15129



Claim Begin-End: AMC427442-AMC427442

3 Transfers



AZ15129-12

AMC364820-AMC427442

PREPARED BY:

AFTER RECORDING RETURN TO:

SPACE ABOVE IS FOR RECORDERS USE

QUIT CLAIM DEED

On 10-13-14 THE GRANTOR(S) Michael Ciummo
 for and in consideration of USA dollars (\$ 1500.00) and/or
 other good and valuable consideration conveys, releases, and quit claims to GRANTEE(S)
JOHN AND MARY J. SCHAEFER 451 N. MERIDIAN APACHE JUNCTION AZ 85120
 (Name and Address)
 the following described unpatented mining claims, situated in the State of
Arizona, in the County of Yavapai.

| BLM SERIAL NUMBER | CLAIM NAME | LEGAL DESCRIPTION |
|-------------------|---------------|---------------------------|
| AMC 427442 | Buried Dreams | S. 26, T11 North, R1 East |
| | | |
| | | |
| | | |
| | | |
| | | |
| | | |
| | | |
| | | |

RECEIVED
 BLM NIZ STATE OFFICE
 2014 OCT 21 P 1:34
 PHOENIX, AZ

Grantor does hereby convey, release and quitclaim _____ percent of the Grantor's rights, title, and interest in and to the above described property and premises to the Grantee(s), and to the Grantee(s) heirs, and assigns forever, so that neither Grantor(s) nor Grantor(s) heirs, legal representatives, or assigns shall have, claim or demand any right or title to the property, premises, or appurtenances, or any part thereof.

Grantor Signature(s) Michael Ciummo

Date: 10-15-2014

INTERESTED
 OCT 27 2014
 BY: pm

RECEIPT # 3153446

(2)

State of Arizona County of Maricopa, ss:

This instrument was acknowledged before me on this 15 day of October
2014 by Michael Gypsy Ciunmmo.

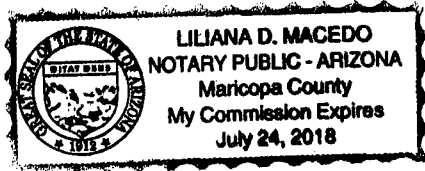

Liliana Macedo
Notary Public

Teller, Bank of America
Title (and Rank)

My Commission Expires: July 24-2018

Notary Address

8828 E. Pinnacle Peak Rd.
Scottsdale AZ 85255

Liliana D. Macedo
Printed Name of Notary Republic
Notary Public for the State of Arizona
Residing at: _____
My Commission Expires: July 24-2018

(Notary Seal)

RECEIVED
BLM, AZ STATE OFFICE
2014 OCT 21 P 1:34
PHOENIX, AZ

MINING CLAIM MAP

Lode () Placer (x)

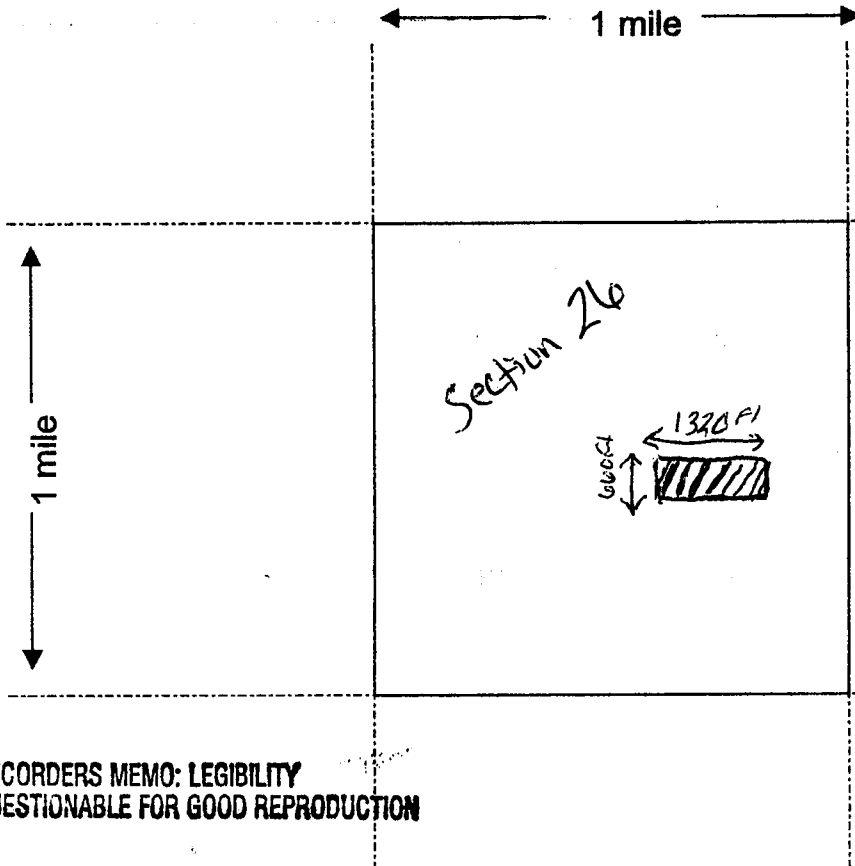

RECORDERS MEMO: LEGIBILITY
QUESTIONABLE FOR GOOD REPRODUCTION

Scale : 1" = 2000 feet



RECEIVED
BLM AZ STATE OFFICE
2014 MAR -4 A 9:13
PHOENIX, ARIZONA

RECEIVED
BLM AZ STATE OFFICE
2014 OCT 21 P 1:34
PHOENIX, AZ

AMC 4274421

1. The above map depicts the Buried Dreams mining claim, which is located in Section (s) 26, Township 11 North, Range 1 East, Gila and Salt River Base and Meridian, _____ County, Arizona.
2. The type of corner and location monuments used are as follows: 2x2 white PVC corner markers
3. The bearings and distances in degrees and feet between claim corners are as depicted on the map.

Form MCF100a
Revised July 2005

United States Department of the Interior
Bureau of Land Management
LANDS/RECREATION & PLANNING
ONE N CENTRAL AVE
PHOENIX, AZ 85004 -2203
Phone: 602-417-9200

Receipt

No: 3153446

| | |
|---|--|
| Transaction #: 3245805 | |
| Date of Transaction: 10/21/2014 | |
| CUSTOMER: | |
| JOHN R SCHAEFER 451 N MERIDIAN RD APACHE JUNCTION, AZ 85120-3622 US | |

| LINE # | QTY | DESCRIPTION | REMARKS | UNIT PRICE | TOTAL |
|---------------|------|--|---------|------------|----------------|
| 1 | 1.00 | LOCATABLE MINERALS / MINING CLAIMS- NOT NEW-UNADJUD, ONE AUTH NO. ONLY / MINING CLAIM MONEY RECEIVED CASES: AMC427442/\$20.00 | QCD - 2 | - n/a - | 20.00 |
| TOTAL: | | | | | \$20.00 |

| PAYMENT INFORMATION | | | | | |
|---------------------|---------|---|-------------|------------|--|
| 1 | AMOUNT: | 20.00 | POSTMARKED: | N/A | |
| | TYPE: | CASH | RECEIVED: | 10/21/2014 | |
| | NAME: | SCHAEFER, JOHN R 451 N MERIDIAN APACHE JUNCTION AZ 85120 US | | | |

| REMARKS |
|---------|
| |

This receipt was generated by the automated BLM Collections and Billing System and is a paper representation of a portion of the official electronic record contained therein.

AMC 427442

When recorded please return to:

Michael Ciummo

1143 E. Juan Tabo Rd.

Scottsdale, AZ 85255

QUITCLAIM DEED

THIS QUITCLAIM DEED, Executed this 26th day of July 2014 by first party Jimmie Cope Jr. whose address is 3716 W. Monona Dr. Glendale, AZ 85308 to second Michael Ciummo whose address is 1143 E. Juan Tabo Rd. Scottsdale, AZ 85255

WITNESSETH, That the said first party, for good consideration and for the sum of \$10.00 paid by the second party, the receipt hereby acknowledged, does hereby remise, release, and quitclaim unto the second party forever, all the right, title, interest and claim which the first party has in and to the following described placer mining claim, in the County of Yavapai, State of Arizona, to wit:

AMC # 427442 Buried Dreams

Exempt per ARS 11-1134 A6

In WITNESS WHEREOF, the said first party has signed and sealed these presents the day and year first above written.

Signed, sealed and delivered:

[Signature] Jimmie Cope
State of Arizona } Arizona

County of } Maricopa

RECEIVED
M AZ STATE OFFICE
2014 AUG 19 P 3:27
PHOENIX, ARIZONA

On this 26th day of July, 2014 before me Jimmie Cope personally appeared, and proved to me on the basis of satisfactory evidence to be the person whose name is subscribed to the within instrument and acknowledged to me that he executed the same in his authorized capacity, and that his signature on the instrument the person, or the entity upon behalf of which the person acted, executed the instrument.

ACKNOWLEDGED by my hand and official notary seal.

[Signature]
Signature

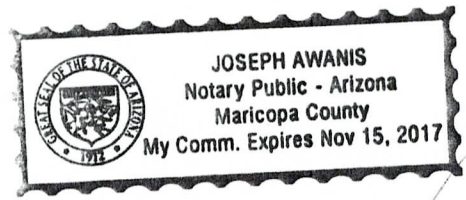

ENTERED
AUG 26 2014
BY: [Signature]

[Signature]
\$10

United States Department of the Interior
Bureau of Land Management
 LANDS/RECREATION & PLANNING
 ONE N CENTRAL AVE
 PHOENIX, AZ 85004 -2203
 Phone: 602-417-9200

Receipt

No: 3105997

| | |
|--|--|
| Transaction #: 3197645 | |
| Date of Transaction: 08/19/2014 | |
| CUSTOMER: | |
| MICHAEL CIUMMO 11433 E JUAN TABO RD SCOTTSDALE, AZ 85255-5706 US | |

| LINE # | QTY | DESCRIPTION | REMARKS | UNIT PRICE | TOTAL |
|---------------|------|---|---------|------------|----------------|
| 1 | 1.00 | LOCATABLE MINERALS / MINING CLAIMS- NOT NEW-UNADJUD, ONE AUTH NO. ONLY / MINING CLAIM MONEY RECEIVED CASES: AMC427442/\$10.00 | TRF/1 | - n/a - | 10.00 |
| TOTAL: | | | | | \$10.00 |

| PAYMENT INFORMATION | | | |
|---|---------------|--|----------------------|
| NOTE: Items will appear on credit card statement as "Bureau of Land Mgmt CO". | | | |
| 1 | AMOUNT: | 10.00 | POSTMARKED: N/A |
| | TYPE: | CREDIT CARD | RECEIVED: 08/19/2014 |
| | NAME: | CIUMMO, MICHAEL 11433 E JUAN TABO RD SCOTTSDALE AZ 85255-5706 US | |
| | CARD NO: | XXXXXXXXXXXX7450 | AUTH CODE: 162493 |
| | NAME ON CARD: | MICHAEL G CIUMMO | |
| | EXPIRES: | 07/2018 | |
| | SIGNATURE: | | |

| |
|---------|
| REMARKS |
| |

This receipt was generated by the automated BLM Collections and Billing System and is a paper representation of a portion of the official electronic record contained therein.

NOTICE!!

These documents have been scanned!

Do not place un-scanned documents beneath this notice!

Do not remove this notice from this file!

GPO Jacket No. 560-102
Print Order 61540
Rise Business Services, LLC
Job=AZ15 6/24/2019



Box Number= AZ15129



Claim Begin-End: AMC427442-AMC427442

4 Annual Filings



AZ15129-12

AMC364820-AMC427442

427442

MAINTENANCE FEE PAYMENT

Claimant Name: JOHN & MARY SCHAEFER
Address: 451 N. MERIDIAN
City: ALACRUZ State: AZ Zip: 85120
Telephone: 480-861-7192
E-mail address: AZ310@JUNO.COM
Signature: John Schaefer

RECEIVED
BLM AZ STATE OFFICE
2020 AUG 12 A 8:03
PHOENIX, ARIZONA
BLM
Date
Stamp

Check here if this is a change of address.

| LINE NO. | AMC NUMBER | CLAIM/SITE NAME | COUNTY RECORDER DATA (If available) | TWP | RNG | SEC |
|----------|------------|-----------------|-------------------------------------|-----|------|-----|
| 1 | 427442 | Buried Dreams | | 526 | T11N | R1E |
| 2 | | | | | | |
| 3 | | | | | | |
| 4 | | | | | | |
| 5 | | | | | | |
| 6 | | | | | | |
| 7 | | | | | | |
| 8 | | | | | | |
| 9 | | | | | | |
| 10 | | | | | | |

List additional claims on Form MCF114.

Bureau of Land Management
Arizona State Office
www.blm.gov/az/

No. of Claims*: 1 x \$165 = 165⁰⁰
Check No: _____ Init. _____
Receipt No.: _____ # 4779557
For BLM Use Only

* ¹⁶⁵\$165 per lode mining claim, mill site, or tunnel site; and ¹⁶⁵\$165 for each 20 acres or portion thereof for each placer mining claim.

Form: MCF112
Revised July 2014

ENTERED
AUG 18 2023
BY: WAC

This form is available from the Arizona Geological Survey and may be reproduced.

United States Department of the Interior
Bureau of Land Management
 DIV OF LANDS, MINRLS & ENERGY
 ONE N CENTRAL AVE
 PHOENIX, AZ 85004 -4427
 Phone: 602-417-9200

Receipt

No: 4779557

| | |
|---|--|
| Transaction #: 4906531 | |
| Date of Transaction: 08/12/2020 | |
| CUSTOMER: | |
| JOHN R SCHAEFER 451 N MERIDIAN RD APACHE JUNCTION, AZ 85120-3622 US | |

| LINE # | QTY | DESCRIPTION | REMARKS | UNIT PRICE | TOTAL |
|---------------|------|---|------------|------------|-----------------|
| 1 | 1.00 | LOCATABLE MINERALS / MINING CLAIMS-NOT NEW-UNADJUD, ONE AUTH NO. ONLY / MINING CLAIM MONEY RECEIVED CASES: AMC427442/\$165.00 | MAINT 2021 | - n/a - | 165.00 |
| TOTAL: | | | | | \$165.00 |

| PAYMENT INFORMATION | | | | |
|---------------------|-----------|--|-------------|------------|
| 1 | AMOUNT: | 165.00 | POSTMARKED: | N/A |
| | TYPE: | CHECK | RECEIVED: | 08/12/2020 |
| | CHECK NO: | 3429 | | |
| | NAME: | SCHAEFER, JOHN R 3213 W MAIN #187 RAPID CITY SD 57702 US | | |

| |
|----------------|
| REMARKS |
| |

This receipt was generated by the automated BLM Collections and Billing System and is a paper representation of a portion of the official electronic record contained therein.

JOHN SCHAEFER
451 N. MERIDIAN
APACHE JUNCTION, AZ
85720

PHOENIX AZ 852

03 AUG 2020 PM 10 L



RECEIVED
BLM AZ STATE OFFICE

2020 AUG 12 A 8:04

PHOENIX, ARIZONA

United States Department of Interior
Bureau of Land Management
One N. Central Ave
PHX., AZ 85004-2203

6500424414 0041



MAINTENANCE FEE PAYMENT

Claimant Name: JOHN R. & MARY J SCHAEFER
 Address: 451 N. MERIDIAN RD
 City: ALBUQUERQUE State: AZ Zip: 85120
 Telephone: 480-861-7192
 E-mail address: AZ310@junior.com
 Signature: [Handwritten Signature]

RECEIVED
 BLM AZ STATE OFFICE
 2019 JUL -3 A 11:59
 PHOENIX, ARIZONA

Check here if this is a change of address.

| LINE NO. | AMC NUMBER | CLAIM/SITE NAME | COUNTY RECORDER DATA (If available) | TWP | RNG | SEC |
|----------|------------|-----------------|-------------------------------------|-----|------|-----|
| 1 | 427442 | Buried Dreams | | S26 | T11N | R1E |
| 2 | | | | | | |
| 3 | | | | | | |
| 4 | | | | | | |
| 5 | | | | | | |
| 6 | | | | | | |
| 7 | | | | | | |
| 8 | | | | | | |
| 9 | | | | | | |
| 10 | | | | | | |

List additional claims on Form MCF114.

No. of Claims*: 1 x \$155 = \$155.00
 Check No: _____ Init. _____
 Receipt No.: _____
 For BLM Use Only # 4503105

Bureau of Land Management
 Arizona State Office
www.blm.gov/az/

* \$155 per lode mining claim, mill site, or tunnel site; and \$155 for each 20 acres or portion thereof for each placer mining claim.

Form: MCF112
 Revised July 2014

ENTERED
 JUL 26 2019
 BY: [Handwritten Signature]

United States Department of the Interior
Bureau of Land Management
 DIV OF LANDS, MINRLS & ENERGY
 ONE N CENTRAL AVE
 PHOENIX, AZ 85004 -4427
 Phone: 602-417-9200

| Receipt | |
|---------|---------|
| No: | 4503105 |

| |
|---|
| Transaction #: 4623477 |
| Date of Transaction: 07/08/2019 |
| CUSTOMER: |
| JOHN R SCHAEFER 451 N MERIDIAN RD APACHE JUNCTION, AZ 85120-3622 US |

| LINE # | QTY | DESCRIPTION | REMARKS | UNIT PRICE | TOTAL |
|---------------|------|--|------------|------------|-----------------|
| 1 | 1.00 | LOCATABLE MINERALS / MINING CLAIMS- NOT NEW-UNADJUD, ONE AUTH NO. ONLY / MINING CLAIM MONEY RECEIVED CASES: AMC427442/\$155.00 | MAINT 2020 | - n/a - | 155.00 |
| TOTAL: | | | | | \$155.00 |

| PAYMENT INFORMATION | | | |
|---------------------|-----------|---|----------------------|
| 1 | AMOUNT: | 155.00 | POSTMARKED: N/A |
| | TYPE: | CHECK | RECEIVED: 07/03/2019 |
| | CHECK NO: | 3349 | |
| | NAME: | SCHAEFER, JOHN R 451 N MERIDIAN RD APACHE JUNCTION AZ 85120-3622 US | |

| REMARKS |
|---|
| THERE HAS BEEN A FEE INCREASE / PLEASE SEE ENCLOSED FLYER |

This receipt was generated by the automated BLM Collections and Billing System and is a paper representation of a portion of the official electronic record contained therein.

United States Department of the Interior
Bureau of Land Management
 DIV OF LANDS, MINRLS & ENERGY
 ONE N CENTRAL AVE
 PHOENIX, AZ 85004 -4427
 Phone: 602-417-9200

Receipt

No: 4503105

| | |
|---|--|
| Transaction #: 4623477 | |
| Date of Transaction: 07/08/2019 | |
| CUSTOMER: | |
| JOHN R SCHAEFER 451 N MERIDIAN RD APACHE JUNCTION, AZ 85120-3622 US | |

| LINE # | QTY | DESCRIPTION | REMARKS | UNIT PRICE | TOTAL |
|---------------|------|---|---------------|------------|-----------------|
| 1 | 1.00 | LOCATABLE MINERALS / MINING CLAIMS- NOT NEW-UNADJUD, ONE AUTH NO. ONLY / MINING CLAIM MONEY RECEIVED CASES: AMC427442/\$155.00 | MAINT 2020 | - n/a - | 155.00 |
| TOTAL: | | | | | \$155.00 |

| PAYMENT INFORMATION | | | | | | |
|---------------------|-----------|---|-------------|------------|--|--|
| 1 | AMOUNT: | 155.00 | POSTMARKED: | N/A | | |
| | TYPE: | CHECK | RECEIVED: | 07/03/2019 | | |
| | CHECK NO: | 3349 | | | | |
| | NAME: | SCHAEFER, JOHN R 451 N MERIDIAN RD APACHE JUNCTION AZ 85120-3622 US | | | | |

| REMARKS |
|---|
| THERE HAS BEEN A FEE INCREASE / PLEASE SEE ENCLOSED FLYER |

This receipt was generated by the automated BLM Collections and Billing System and is a paper representation of a portion of the official electronic record contained therein.

RECEIVED
 BLM AZ STATE OFFICE
 PHOENIX, ARIZONA
 2019 AUG -6 P 2:59

ENTERED
 AUG 13 2019
 BY: 

4527420



United States Department of the Interior

BUREAU OF LAND MANAGEMENT
Arizona State Office
One North Central Avenue, Suite 800
Phoenix, Arizona 85004-4427
www.blm.gov/az/

IMPORTANT NOTICE

ANNUAL MAINTENANCE FEES AND MINING CLAIM LOCATION FEES HAVE INCREASED

Effective July 1, 2019, the annual maintenance fee for mining claims increased from \$155 to **\$165 per claim**. (Placer claims over 20 acres must pay an additional \$165 for each 20 acres or portion thereof.)

NEW FEES ARE DUE FOR THE 2020 ASSESSMENT YEAR ON OR BEFORE SEPTEMBER 1, 2019.

If you have already paid your 2020 maintenance fee payment, you must send in the additional \$10 per claim, prior to September 1, 2019. (Placer mining claims over 20 acres must send in an additional \$10 per 20 acres or portion thereof.)

Effective July 1, 2019, the location fee has increased from \$37 to **\$40 per claim**. **New mining claims located on or after September 1, 2019, will cost a total of \$225 per mining claim**. This includes a \$40 location fee, \$165 maintenance fee, and \$20 processing fee. (Placer claims over 20 acres must pay an additional \$165 for each 20 acres or portion thereof.)

REMINDER: As of October 1, 2018, processing fees for Transfers, Amendments, Affidavit of Labor and Notice of Intent to Locate increased from \$10 to **\$15 per claim**.

*The fee adjustment is published in the Federal Register on July 1, 2019, 84 FR31219. The text is accessible on the Federal Register website (www.federalregister.gov).

**NOW AVAILABLE!!! PAY YOUR ANNUAL MINING CLAIM
MAINTENANCE FEES ON-LINE
GO TO: www.blm.gov/payportal/home.html**

For questions please contact our Public Room at 602-417-9528.

PHOENIX ARIZONA

2019 AUG - 2: 50

RECEIVED
BLM AZ STATE OFFICE

RECEIVED
 BLM AZ STATE OFFICE
 2019 AUG - 6 P 2:56
 PHOENIX, ARIZONA
 RECEIVED
 BLM AZ STATE OFFICE
 2019 JUL - 3 A 11:59
 PHOENIX, ARIZONA

MAINTENANCE FEE PAYMENT

Claimant Name: JOHN R & MARY J SCHAEFER
 Address: 451 N. MCDONALD RD
 City: Apache Junction State: AZ Zip: 85120
 Telephone: 480-861-7152
 E-mail address: A2310@jupco.com
 Signature: [Handwritten Signature]

BLM Date Stamp

Check here if this is a change of address.

| LINE NO. | AMC NUMBER | CLAIM/SITE NAME | COUNTY RECORDER DATA (If available) | TWP | RNG | SEC |
|----------|------------|-----------------|-------------------------------------|-----|------|-----|
| 1 | 427442 | Buried Dreams | | 526 | T11N | R1E |
| 2 | | | | | | |
| 3 | | | | | | |
| 4 | | | | | | |
| 5 | | | | | | |
| 6 | | | | | | |
| 7 | | | | | | |
| 8 | | | | | | |
| 9 | | | | | | |
| 10 | | | | | | |

List additional claims on Form MCF114.

Bureau of Land Management
 Arizona State Office
www.blm.gov/az/

No. of Claims*: 1 x \$155 = \$155.00
 Check No: _____ Init. _____
 Receipt No.: _____
 For BLM Use Only # 4503105

* \$155 per lode mining claim, mill site, or tunnel site; and \$155 for each 20 acres or portion thereof for each placer mining claim.

Form: MCF112
 Revised July 2014

United States Department of the Interior
Bureau of Land Management
 DIV OF LANDS, MINRLS & ENERGY
 ONE N CENTRAL AVE
 PHOENIX, AZ 85004 -4427
 Phone: 602-417-9200

| | |
|---------|---------|
| Receipt | |
| No: | 4527420 |

| | |
|---|--|
| Transaction #: 4648181 | |
| Date of Transaction: 08/08/2019 | |
| CUSTOMER: | |
| JOHN R SCHAEFER 451 N MERIDIAN RD APACHE JUNCTION, AZ 85120-3622 US | |

| LINE # | QTY | DESCRIPTION | REMARKS | UNIT PRICE | TOTAL |
|---------------|------|--|-----------------|------------|----------------|
| 1 | 1.00 | LOCATABLE MINERALS / MINING CLAIMS-NOT NEW-UNADJUD, ONE AUTH NO. ONLY / MINING CLAIM MONEY RECEIVED CASES: AMC427442/\$10.00 | ADDITIONAL FEES | - n/a - | 10.00 |
| TOTAL: | | | | | \$10.00 |

| PAYMENT INFORMATION | | | |
|---------------------|-----------|---|----------------------|
| 1 | AMOUNT: | 10.00 | POSTMARKED: N/A |
| | TYPE: | CHECK | RECEIVED: 08/06/2019 |
| | CHECK NO: | 3352 | |
| | NAME: | SCHAEFER, JOHN R 451 N MERIDIAN RD APACHE JUNCTION AZ 85120-3622 US | |

| |
|---------|
| REMARKS |
| |

This receipt was generated by the automated BLM Collections and Billing System and is a paper representation of a portion of the official electronic record contained therein.

Amc 427442

MAINTENANCE FEE PAYMENT

Claimant Name: JOHN & MARY J. SCHAEFER
 Address: 451 N. MERIDIAN RD
 City: ACHES, JUNIOR State: AZ Zip: 85120
 Telephone: 480-861-7192
 E-mail address: AZ310@JUNO.COM
 Signature: John R. Schaefer

RECEIVED
 BLM AZ STATE OFFICE
 2018 JUL -2 P 2:18
 PHOENIX, ARIZONA
 BLM
 Date
 Stamp

Check here if this is a change of address.

| LINE NO. | AMC NUMBER | CLAIM/SITE NAME | COUNTY RECORDER DATA (If available) | TWP | RNG | SEC |
|----------|------------|-----------------|-------------------------------------|-----|------|-----|
| 1 | 427442 | BURIED DREAMS | | S26 | T11N | R1E |
| 2 | | | | | | |
| 3 | | | | | | |
| 4 | | | | | | |
| 5 | | | | | | |
| 6 | | | | | | |
| 7 | | | | | | |
| 8 | | | | | | |
| 9 | | | | | | |
| 10 | | | | | | |

List additional claims on Form MCF114.

Bureau of Land Management
Arizona State Office
www.blm.gov/az/

No. of Claims*: 1 x \$155 = _____
 Check No: _____ Init. _____
 Receipt No.: 4205665
 For BLM Use Only

* \$155 per lode mining claim, mill site, or tunnel site; and \$155 for each 20 acres or portion thereof for each placer mining claim.

Form: MCF112
Revised July 2014

This form is available from the Arizona Geological Survey and may be reproduced.

ENTERED
 JUL 12 2018
 BY: fm

JOHN R SCHAEFER
451 N. MEDICIAN RD
APACHE JUNCTION, AZ

PHOENIX AZ 852

29 JUN 2018 PM 5 L

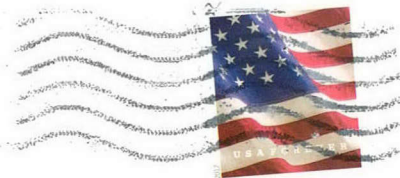

85218

RECEIVED
BLM STATE OFFICE

2018 JUL -2 P 2:18

PHOENIX, ARIZONA

Bureau of Land Management
1 North Central Ave
Suite 800
Phoenix, AZ 85004

85004-442700

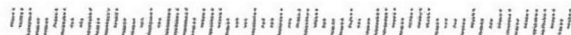

United States Department of the Interior
Bureau of Land Management
 DIV OF LANDS, MINRLS & ENERGY
 ONE N CENTRAL AVE
 PHOENIX, AZ 85004 -4427
 Phone: 602-417-9200

Receipt

No: 4205665

| | |
|--|--|
| Transaction #: 4320610 | |
| Date of Transaction: 07/05/2018 | |
| CUSTOMER: | |
| JOHN R SCHAEFER 3213 W MAIN ST # 187 RAPID CITY,SD 57702-2314 US | |

| LINE # | QTY | DESCRIPTION | REMARKS | UNIT PRICE | TOTAL |
|---------------|------|--|-----------------|------------|-----------------|
| 1 | 1.00 | LOCATABLE MINERALS / MINING CLAIMS- NOT NEW-UNADJUD, ONE AUTH NO. ONLY / MINING CLAIM MONEY RECEIVED CASES: AMC427442/\$155.00 | MAINT 2019/1 | - n/a - | 155.00 |
| TOTAL: | | | | | \$155.00 |

| PAYMENT INFORMATION | | | |
|---------------------|-----------|---|----------------------|
| 1 | AMOUNT: | 155.00 | POSTMARKED: N/A |
| | TYPE: | CHECK | RECEIVED: 07/02/2018 |
| | CHECK NO: | 3281 | |
| | NAME: | SCHAEFER, JOHN R 3213 W MAIN ST # 187 RAPID CITY SD 57702-2314 US | |

| |
|---------|
| REMARKS |
| |

This receipt was generated by the automated BLM Collections and Billing System and is a paper representation of a portion of the official electronic record contained therein.

427442

MAINTENANCE FEE PAYMENT

Claimant Name: JOHN & MARY J. SCHAEFER
Address: 451 N. MERIDIAN RD
City: APACHE JUNCTION State: AZ Zip: 85120
Telephone: 480-861-7192
E-mail address: AZ310@Juno.com
Signature: John Schaefer

BLM
Date
Stamp

RECEIVED
BLM STATE OFFICE
PHOENIX, ARIZONA
2017 JUL -3 P 2:40

Check here if this is a change of address.

| LINE NO. | AMC NUMBER | CLAIM/SITE NAME | COUNTY RECORDER DATA (If available) | TWP | RNG | SEC |
|----------|------------|-----------------|-------------------------------------|-----|------|-----|
| 1 | 427442 | BURIED DREAMS | | 32N | T11N | R1E |
| 2 | | | | | | |
| 3 | | | | | | |
| 4 | | | | | | |
| 5 | | | | | | |
| 6 | | | | | | |
| 7 | | | | | | |
| 8 | | | | | | |
| 9 | | | | | | |
| 10 | | | | | | |

List additional claims on Form MCF114.

No. of Claims*: 3169 x \$155 = 155
Check No: 3169 Init. JMS
Receipt No.: 3079988
For BLM Use Only

Bureau of Land Management
Arizona State Office
www.blm.gov/az/

* \$155 per lode mining claim, mill site, or tunnel site; and \$155 for each 20 acres or portion thereof for each placer mining claim.

Form: MCF112
Revised July 2014

This form is available from the Arizona Geological Survey and may be reproduced.

INTERESTED
JUL 11 2017
BY: RAM

JOHN SCHAEFER
451 N. MERIDIAN RD
APACHE JUNCTION, AZ
85720

PHOENIX AZ 852

30 JUN 2017 PM 4 L



United States Department of Interior
Bureau of Land Management
Dir of Land, Minerals & Energy
One N. Central Ave
Phoenix, AZ 85004-4424

PHOENIX ARIZONA

2017 JUL -3 P 2:40

RECEIVED
BLM AZ STATE OFFICE

United States Department of the Interior
Bureau of Land Management
 DIV OF LANDS, MINRLS & ENERGY
 ONE N CENTRAL AVE
 PHOENIX, AZ 85004 -4427
 Phone: 602-417-9200

Receipt

No: 3879988

| | |
|---|--|
| Transaction #: 3989096 | |
| Date of Transaction: 07/05/2017 | |
| CUSTOMER: | |
| JOHN R SCHAEFER 451 N MERIDIAN RD APACHE JUNCTION, AZ 85120-3622 US | |

| LINE # | QTY | DESCRIPTION | REMARKS | UNIT PRICE | TOTAL |
|---------------|------|---|-----------------|------------|-----------------|
| 1 | 1.00 | LOCATABLE MINERALS / MINING CLAIMS- NOT NEW-UNADJUD, ONE AUTH NO. ONLY / MINING CLAIM MONEY RECEIVED CASES: AMC427442/\$155.00 | MAINT 2018/1 | - n/a - | 155.00 |
| TOTAL: | | | | | \$155.00 |

| PAYMENT INFORMATION | | | |
|---------------------|-----------|--|----------------------|
| 1 | AMOUNT: | 155.00 | POSTMARKED: N/A |
| | TYPE: | CHECK | RECEIVED: 07/03/2017 |
| | CHECK NO: | 3189 | |
| | NAME: | SCHAEFER, JOHN R 3213 W MAIN UNIT 187 RAPID CITY SD 57702 US | |

| |
|---------|
| REMARKS |
| |

This receipt was generated by the automated BLM Collections and Billing System and is a paper representation of a portion of the official electronic record contained therein.

427442

MAINTENANCE FEE PAYMENT

Claimant Name: JOHN & MARY J. SCHAEFER
Address: 451 N Meridian Rd
City: HALETTE JUNIOR State: AZ Zip: 85120
Telephone: 480-861-7192
E-mail address: AZ310@junior.com
Signature: [Handwritten Signature]

RECEIVED
BLM ARIZONA OFFICE
2016 JUL -5 A 9:08
PHOENIX, ARIZONA
BLM
Date
Stamp

Check here if this is a change of address.

| LINE NO. | AMC NUMBER | CLAIM/SITE NAME | COUNTY RECORDER DATA (If available) | TWP | RNG | SEC |
|----------|------------|-----------------|-------------------------------------|-----|------|-----|
| 1 | 427442 | BURIED DREAMS | | 526 | T11N | R1E |
| 2 | | | | | | |
| 3 | | | | | | |
| 4 | | | | | | |
| 5 | | | | | | |
| 6 | | | | | | |
| 7 | | | | | | |
| 8 | | | | | | |
| 9 | | | | | | |
| 10 | | | | | | |

List additional claims on Form MCF114.

**Bureau of Land Management
Arizona State Office**

No. of Claims*: 1 x \$155 = 155
Check No.: 3199 Init. [Handwritten]
Receipt No.: 3600054
For BLM Use Only

* \$155 per lode mining claim, mill site, or tunnel site; and \$155 for each 20 acres or portion thereof for each placer mining claim.

**Form: MCF112
Revised July 2014**

This form is available from the Arizona Geological Survey and may be reproduced.

ENTERED
JUL 11 2016
BY: RAM

John Schaefer
451 N. Meridian
Apache Junction, AZ
85120

PHOENIX AZ 852

30 JUN 2016 PM 11 L



RECEIVED
BLM ARIZONA STATE OFFICE

2016 JUL -5 A 9:02

PHOENIX, ARIZONA

BLM Staley Ag.
One North Central Ave
Suite 800
PHX., AZ 85004-4427

8500464414 C041



United States Department of the Interior
Bureau of Land Management
 DIV OF LANDS, MINRLS & ENERGY
 ONE N CENTRAL AVE
 PHOENIX, AZ 85004 -4427
 Phone: 602-417-9200

Receipt

No: 3600054

| | |
|---|--|
| Transaction #: 3703401 | |
| Date of Transaction: 07/06/2016 | |
| CUSTOMER: | |
| JOHN R SCHAEFER 451 N MERIDIAN RD APACHE JUNCTION, AZ 85120-3622 US | |

| LINE # | QTY | DESCRIPTION | REMARKS | UNIT PRICE | TOTAL |
|---------------|------|---|-----------------|------------|-----------------|
| 1 | 1.00 | LOCATABLE MINERALS / MINING CLAIMS- NOT NEW-UNADJUD, ONE AUTH NO. ONLY / MINING CLAIM MONEY RECEIVED CASES: AMC427442/\$155.00 | MAINT 2017/1 | - n/a - | 155.00 |
| TOTAL: | | | | | \$155.00 |

| PAYMENT INFORMATION | | | |
|---------------------|-----------|--|------------------------|
| 1 | AMOUNT: | 155.00 | POSTMARKED: 06/30/2016 |
| | TYPE: | CHECK | RECEIVED: 07/05/2016 |
| | CHECK NO: | 3199 | |
| | NAME: | SCHAEFER, JOHN R 3213 W MAIN UNIT 187 RAPID CITY SD 57702 US | |

| |
|---------|
| REMARKS |
| |

This receipt was generated by the automated BLM Collections and Billing System and is a paper representation of a portion of the official electronic record contained therein.

427442

When Recorded Return Document to:

JOHN SCHAEFER
451 N MERIDIAN
APACHE JUNCTION, AZ
85120

Check here is this is a change of address.

Telephone: _____

E-mail address: _____

AFFIDAVIT OF PERFORMANCE OF ANNUAL WORK

1. State of Arizona, County of MARICOPA ss:

2. I (Name) JOHN SCHAEFER

3. Reside at (Address) 451 N MERIDIAN

City APACHE JUNCTION County PINAL

State AZ Zip 85120 being duly sworn, depose and say that I am a citizen of the United States, more than eighteen years of age, and that all of the facts set forth in this affidavit, subject to the provisions and penalties of 18 U.S.C. 1001 pertaining to the filing of false, fictitious, or fraudulent statements with the United States, are true and correct according to the best of my knowledge, information and belief.

4. Owner's name and address (If not shown in Items 1-3 above). _____

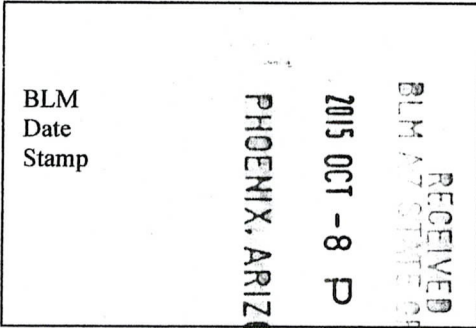

5. That I am personally acquainted with the mining claim(s). The work and improvements were made by and at the expense of the owner(s) of said claim(s). Said contiguous group of claims, listed on this document, are situated in the

_____ (optional) Mining District; _____ County, Arizona.

| Line No. | AMC NUMBER | CLAIM/SITE NAME | COUNTY RECORDER DATA (If available) | TWP | RNG | SEC |
|----------|------------|-----------------|-------------------------------------|-------|------|-----|
| 1 | 427442 | BURIED DREAMS | | 11-N. | 1-E. | 26 |
| 2 | | | | | | |
| 3 | | | | | | |
| 4 | | | | | | |
| 5 | | | | | | |
| 6 | | | | | | |

Form: MCF108
Revised July 2014
Page 1 of 2

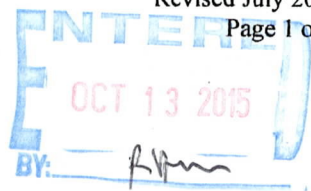

RECEIVED
BLM ARIZONA STATE OFFICE
2015 OCT - 8 P 2: 52
PHOENIX, ARIZONA

BLM
Date
Stamp

| | | | | | |
|----|--|--|--|--|--|
| 7 | | | | | |
| 8 | | | | | |
| 9 | | | | | |
| 10 | | | | | |

6. That between the dates starting at 12 o'clock noon on September 1, 20 14 and ending at 12 o'clock noon on September 1, 20 15 at least \$ 120.00 dollars worth of work and improvements were done and performed upon said claim(s) or upon one or more of a contiguous group of claims for the benefit of all, wholly or partly outside of a contiguous group of claims for the benefit of all, not including the location work.

7. That the following persons were employed to perform the work and improvements described herein: _____

John & Mary Schaefer

8. That the work and improvements performed were: Filling in washabout road ways
through out the claim making it passable

9. Dated: 10-05-15 Signature: John R. Schaefer

SUBSCRIBED AND SWORN TO before me, a Notary Public, this 05 day of October 20 15

By: John Schaefer
Notary Public Kricina Perea

My Commission Expires 01/14/2019

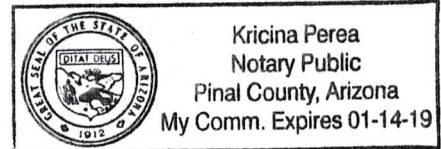

Bureau of Land Management
Arizona State Office
www.blm.gov/az

No. of Claims: 1 x \$10 = 10.00
Check No.: 3101 Init. JRS
Receipt No.: 3410052
For BLM Use Only

JOHN Schaefer
451 N. Meridian
APACHE Junction AZ
85720

RECEIVED
SEM AZ STATE OFFICE

2015 OCT -8 P 2:47

PHOENIX, ARIZONA

Bureau of Land Management
One N. Central Ave
Suite 800
Phoenix, AZ 85004-4427

PHOENIX AZ 852

06 OCT 2015 PM 11 L



85004442700



United States Department of the Interior
Bureau of Land Management
 LANDS/RECREATION & PLANNING
 ONE N CENTRAL AVE
 PHOENIX, AZ 85004 -2203
 Phone: 602-417-9200

Receipt

No: 3410052

| | |
|---|--|
| Transaction #: 3508792 | |
| Date of Transaction: 10/09/2015 | |
| CUSTOMER: | |
| JOHN R SCHAEFER 451 N MERIDIAN RD APACHE JUNCTION, AZ 85120-3622 US | |

| LINE # | QTY | DESCRIPTION | REMARKS | UNIT PRICE | TOTAL |
|---------------|------|---|------------|------------|----------------|
| 1 | 1.00 | LOCATABLE MINERALS / MINING CLAIMS- NOT NEW-UNADJUD, ONE AUTH NO. ONLY / MINING CLAIM MONEY RECEIVED CASES: AMC427442/\$10.00 | POL 2015/1 | - n/a - | 10.00 |
| TOTAL: | | | | | \$10.00 |

| PAYMENT INFORMATION | | | | | |
|---------------------|-----------|---|-------------|------------|--|
| 1 | AMOUNT: | 10.00 | POSTMARKED: | 10/06/2015 | |
| | TYPE: | CHECK | RECEIVED: | 10/08/2015 | |
| | CHECK NO: | 3101 | | | |
| | NAME: | SCHAEFER, JOHN R 451 N MERIDIAN RD APACHE JUNCTION AZ 85120-3622 US | | | |

| |
|---------|
| REMARKS |
| |

This receipt was generated by the automated BLM Collections and Billing System and is a paper representation of a portion of the official electronic record contained therein.

UNITED STATES
DEPARTMENT OF THE INTERIOR
BUREAU OF LAND MANAGEMENT
**MAINTENANCE FEE PAYMENT FORM
FOR PLACER MINING CLAIMS**

427442
399213

Remitter Name: JOHN R SCHAEFER
Mailing Address: 451 N. MENDIAN RD
City, State, Zip: APACHE JUNCTION, AZ 85120
 Check here if this is a change of address.

FOR COUNTY RECORDER'S USE

No. of claims 2
Total due BLM \$ 465.00

- The maintenance fee may be paid by cash, check, money order, Bureau of Land Management (BLM) Declining Deposit Account, or credit card (VISA, American Express, Discover, or MasterCard). Payments must be remitted to the BLM State Office where your claim or site is recorded and received on or before September 1. If the payment is mailed, the envelope must be postmarked by a bona fide delivery service on or before September 1 and received at the proper BLM State Office within 15 calendar days after the due date. Payments may also be made by telephone using a credit card. A complete listing of BLM State Offices with their addresses and phone numbers can be found at <http://www.blm.gov>.
- The maintenance fee for the following claim(s) applies to the assessment year 2015-2016

| CLAIM NAME | BLM SERIAL NO. | ACRES IN CLAIM | PAYMENT DUE TO THE BLM (See Instructions on Page 2) |
|---------------|----------------|----------------|--|
| BURIED DREAMS | AMC 427442 | 20 | 155.00 |
| COYOTE WASH 2 | AMC 399217 | 40 | 310.00 |
| | | | |
| | | | |
| | | | |
| | | | |
| | | | |
| | | | |
| | | | |

BLM RECEIVED
2015 JUL 21 P 3:12
PHOENIX, ARIZONA

Use a separate sheet for additional claim names, serial numbers, and claimant names and addresses.

(Continued on page 2)

JUL 24 2015 # 3347961
BY: RAM

INSTRUCTIONS

1. This is an optional form that may be used to satisfy the requirements for the Bureau of Land Management (BLM) under the provisions of 43 U.S.C. §1744 and 30 U.S.C. §28f and the regulations thereunder (43 CFR part 3834). Since local and State laws may vary, you should contact your local and State agencies where the claims are located to ensure all applicable laws and requirements are satisfied.
2. This form should be used to pay the maintenance fee for placer mining claims only. To pay the maintenance fee for lode mining claims, mill sites or tunnel sites, use Form 3830-5.
3. Complete the section for the number of claims and the amount being remitted to the BLM.
4. Enter the year in paragraph 2 for the applicable assessment year.
5. List all mining claim names and the BLM serial number associated to the claim if the BLM has notified you what the serial number is. Every attempt should be made to include the current BLM serial number for each claim listed. List the acreage for each claim and the amount due based on the acreage. See the chart below for amounts due.
6. The maintenance fee for placer mining claims is paid for every 20 acres of the claim **or portion thereof**. When making a maintenance fee payment for your placer claim, you should make your payment in accordance with the following chart:

| Number of acres in the claim | Maintenance Fee Payment Due Per Claim |
|-------------------------------|--|
| < = 20 acres | \$155 |
| > 20 acres but < = 40 acres | \$310 |
| > 40 acres but < = 60 acres | \$465 |
| > 60 acres but < = 80 acres | \$620 |
| > 80 acres but < = 100 acres | \$775 |
| > 100 acres but < = 120 acres | \$930 |
| > 120 acres but < = 140 acres | \$1,085 |
| > 140 acres but < = 160 acres | \$1,240 |
| > 160 acres | Contact the BLM |

Legend: > means greater than; < means less than; = means equal to

7. The name and current mailing addresses of the person paying the maintenance fee(s) should be listed at the top of the form. If this is a change of address for a claimant, that should also be noted.
8. If needed, an additional sheet can be used to continue listing claim names, BLM serial numbers, acres in claim, payment due or the name and current mailing address of additional claimants.
9. If paying by credit card, you must complete the following credit card information on page 4: (a) exact name on the face of the credit card; (b) amount paid; (c) type of card; (d) credit card number; (e) expiration date of the card; and (f) telephone number. You must also sign page 4 to show authorization to charge the credit card.

NOTICES

THE PRIVACY ACT and 43 CFR 2.48(d) require that you be furnished with the following information in connection with the information requested by this form.

AUTHORITY: 30 U.S.C. 28f and 43 CFR part 3834 permit collection of the information requested by this form.

PRINCIPAL PURPOSE: The BLM will use the information you provide to record the annual maintenance fee payment for the claims listed and to verify that payment has been made in accordance with 30 U.S.C. 28f and 43 CFR part 3834.

ROUTINE USES: The BLM will only disclose this information in accordance with the provisions at 43 CFR 2.56(b) and (c).

EFFECT OF NOT PROVIDING INFORMATION: Disclosure of the requested information is required by 30 U.S.C. 28f and 43 CFR part 3834 for claimants paying the annual maintenance fee. The use of this specific form when paying the maintenance fee is optional. However, when paying the maintenance fee, it is the requested information on this form that is required to be submitted along with the fee. Failure to submit all the required information will delay the BLM's processing of the information and may preclude the BLM's acceptance of the maintenance fee payment, which may result in forfeiture of the mining claim(s) by the claimant.

JOHN R SCHAEFER
451 N. MERIDIAN RD
APACHE JUNCTION, AZ 85120

PHOENIX AZ 852

16 JUL 2015 PM 4 L



RECEIVED
DEMOCRATIC OFFICE

2015 JUL 21 P 2:56

PHOENIX, ARIZONA

BUREAU OF LAND MANAGEMENT
ONE NORTH CENTRAL AVE.
SUITE 800
PHX, AZ. 85004-4427

85004442700



JOHN R SCHAEFER
451 N. MERIDIAN RD
APACHE JUNCTION, AZ 85120

PHOENIX AZ 852

16 JUL 2015 PM 4 L

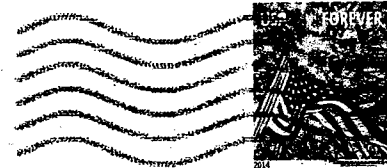

RECEIVED
POST OFFICE

2015 JUL 21 P 2:56

PHOENIX, ARIZONA

BUREAU OF LAND MANAGEMENT
ONE NORTH CENTRAL AVE.
SUITE 800
PHX, AZ. 85004-4427

85004442700

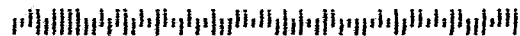

United States Department of the Interior
Bureau of Land Management
 LANDS/RECREATION & PLANNING
 ONE N CENTRAL AVE
 PHOENIX, AZ 85004 -2203
 Phone: 602-417-9200

Receipt

No: 3347961

| | |
|---|--|
| Transaction #: 3445771 | |
| Date of Transaction: 07/22/2015 | |
| CUSTOMER: | |
| JOHN R SCHAEFER 451 N MERIDIAN RD APACHE JUNCTION, AZ 85120-3622 US | |

| LINE # | QTY | DESCRIPTION | REMARKS | UNIT PRICE | TOTAL |
|---------------|------|--|-----------------|------------|-----------------|
| 1 | 1.00 | LOCATABLE MINERALS / MINING CLAIMS- NOT NEW-UNADJUD, ONE AUTH NO. ONLY / MINING CLAIM MONEY RECEIVED CASES: AMC399217/\$465.00 | MAINT 2016/2 | - n/a - | 465.00 |
| TOTAL: | | | | | \$465.00 |

| PAYMENT INFORMATION | | | | | |
|---------------------|-----------|--|-------------|------------|--|
| 1 | AMOUNT: | 465.00 | POSTMARKED: | 07/16/2015 | |
| | TYPE: | CHECK | RECEIVED: | 07/21/2015 | |
| | CHECK NO: | 3093 | | | |
| | NAME: | SCHAEFER, JOHN R 3213 W MAIN UNIT 187 RAPID CITY SD 57702 US | | | |

| |
|---------|
| REMARKS |
| |

This receipt was generated by the automated BLM Collections and Billing System and is a paper representation of a portion of the official electronic record contained therein.

ENTERED
 JUL 24 2015
 BY: *[Signature]*

1348

JMC

MAINTENANCE FEE WAIVER CERTIFICATION

FORM APPROVED
OMB NO. 1004-0114
Expires: October 31, 2016

427442

SEE INSTRUCTIONS ON PAGE 2

- This small miner waiver is filed for the assessment year beginning on September 1, 2014 and ending on September 1, 2015.
- The undersigned and all related parties owned ten or fewer mining claims, mill, or tunnel sites located and maintained on Federal lands in the United States of America on September 1, 2014.
- The undersigned have performed the assessment work required by law for each mining claim listed prior to filing this waiver and understand that by filing this form, the undersigned must file an affidavit of assessment work with the Bureau of Land Management (BLM) by the December 30th following the filing of this waiver.
- The undersigned understand that if the assessment work obligation has not yet come due under 30 U.S.C. 28 (for those claims in their first assessment year only), a notice of intent to hold reciting this condition must be recorded by the December 30th following the filing of this waiver.
- The undersigned understand that mill and tunnel sites may also be listed on this waiver and be waived from payment of the maintenance fee, and that a notice of intent to hold for these sites is required to be filed with the BLM by the December 30th following the filing of this waiver.
- The undersigned understand and acknowledge that pursuant to 43 U.S.C. 1212 and 18 U.S.C. 1001, the filing or recording of a false, fictitious, or fraudulent document with the BLM may result in a fine of up to \$250,000, a prison term not to exceed five years, or both.
- The mining claims, mill or tunnel sites for which this waiver from payment of the maintenance fees is requested are:

| CLAIM OR SITE NAME | BLM RECORDATION SERIAL NUMBER |
|--------------------|-------------------------------|
| 1. Buried Dreams | 427442 |
| 2. | |
| 3. | |
| 4. | |
| 5. | |
| 6. | |
| 7. | |
| 8. | |
| 9. | |
| 10. | |

The owner(s) (claimants) of the above mining claims and sites are:

Michael Ciunmo
 (Owner's Name - Please Print)
 11433 E Juan Tabo RD
 (Owner's Mailing Address)

Michael Ciunmo
 (Owner's Signature)
 Scottsdale AZ 85255
 (City) (State) (Zip Code)

(Owner's Name - Please Print)
 (Owner's Mailing Address)

(Owner's Signature)
 (City) (State) (Zip Code)

(Owner's Name - Please Print)
 (Owner's Mailing Address)

(Owner's Signature)
 (City) (State) (Zip Code)

(Owner's Name - Please Print)
 (Owner's Mailing Address)

(Owner's Signature)
 (City) (State) (Zip Code)

RECEIVED
 M AZ STATE OFFICE
 2014 AUG 19 P 3:37
 PHOENIX, ARIZONA

ENTERED
 SEP 11 2014
 BY: RE

NEW
 9-18-14

(Owner's Name - Please Print)

(Owner's Signature)

(Owner's Mailing Address)

(City)

(State)

(Zip Code)

(Owner's Name - Please Print)

(Owner's Signature)

(Owner's Mailing Address)

(City)

(State)

(Zip Code)

(Owner's Name - Please Print)

(Owner's Signature)

(Owner's Mailing Address)

(City)

(State)

(Zip Code)

(Owner's Name - Please Print)

(Owner's Signature)

(Owner's Mailing Address)

(City)

(State)

(Zip Code)

18 U.S.C. 1001 and 43 U.S.C. 1212 make it a crime for any person knowingly and willfully to make to any department or agency of the United States any false, fictitious or fraudulent statements or representations as to any matter within its jurisdiction.

INSTRUCTIONS

- 1. This certification is made under the provisions of 43 U.S.C. § 1744 and 30 U.S.C. §28-28k and the regulations thereunder (43 CFR Part 3830).
- 2. The claimant(s) must fill in the dates in paragraph 1 for the beginning and ending of the assessment year for which this waiver is sought.
- 3. The claimant(s) must fill in the date in paragraph 2 for the beginning of the assessment year for which this waiver is sought.
- 4. All claim and site names and BLM serial numbers must be listed for the mining claims, mill sites, and tunnel sites for which the waiver is sought.
- 5. All owners of the mining claims, mill sites, and tunnel sites and their addresses must be given.
- 6. This waiver form must be signed by all the claimants or their designated agent, in original form. If an agent is designated, a notarized designation of agent, signed by all of the claimants with proper address given, must be submitted with this waiver.
- 7. This form must be filed no later than September 1st for the upcoming assessment year in the BLM State Office where the mining claims or sites are recorded, or the waiver cannot be granted by the BLM. (Example: To obtain a waiver for the assessment year 2012, which begins on September 1, 2011, you must qualify for and file for a waiver no later than September 1, 2011, in the proper BLM State Office.)
- 8. For all mining claims which require assessment work, you must record an affidavit of labor on or before the December 30th immediately following the filing of this waiver. For all other mining claims or sites waived, you must record a notice of intent to hold on or before the December 30th immediately following the filing of this waiver.
- 9. Mill and tunnel sites may also be listed on this waiver and be waived from payment of the maintenance fee. A notice of intent to hold for these sites is required to be filed by the December 30th following the filing of this waiver.

BLM AZ STATE OFFICE RECEIVED
PHOENIX, ARIZONA
AUG 19 2014 3:31

PHOENIX, ARIZONA
AUG 19 2014 3:31
RECEIVED
BLM AZ STATE OFFICE

FOR OFFICIAL USE ONLY

427442

When Recorded Return Document to:

Michael Ciunmo
11433 E Juan Tabo RD
Scottsdale, AZ 85255

Check here is this is a change of address.

Telephone: 602-653-9183

E-mail address: MichaelCiunmo@Hotmail.com

RECEIVED
AZ STATE OFFICE
AUG 19 P 3:37
PHOENIX, ARIZONA

AFFIDAVIT OF PERFORMANCE OF ANNUAL WORK

1. State of Arizona, County of U.S.A ss:

2. I (Name) Michael Ciunmo

3. Reside at (Address) 11433 E Juan Tabo RD

Scottsdale County U.S.A

BLM
Date
Stamp

State AZ zip 85255 being duly sworn, depose and say that I am a citizen of the United States, more than eighteen years of age, and that all of the facts set forth in this affidavit, subject to the provisions and penalties of 18 U.S.C. 1001 pertaining to the filing of false, fictitious, or fraudulent statements with the United States, are true and correct according to the best of my knowledge, information and belief.

4. Owner's name and address (If not shown in Items 1-3 above).

5. That I am personally acquainted with the mining claim(s). The work and improvements were made by and at the expense of the owner(s) of said claim(s). Said contiguous group of claims, listed on this document, are situated in the

Yavapai (optional) Mining District; Yavapai County, Arizona.

| Line No. | AMC NUMBER | CLAIM/SITE NAME | COUNTY RECORDER DATA (If available) | TWP | RNG | SEC |
|----------|------------|-----------------|-------------------------------------|-----|-----|-----|
| 1 | 427442 | Buried Dreams | Yavapai county | 71 | 1 | 26 |
| 2 | | | | | | |
| 3 | | | | | | |
| 4 | | | | | | |
| 5 | | | | | | |
| 6 | | | | | | |

Form: MCF108
Revised Jan. 2006
Page 1 of 2

ENTERED
AUG 20 2014
BY: RAM

RECEIVED
 MARICOPA STATE OFFICE
 PHOENIX, ARIZONA
 2014 AUG 19 P 3:37
 BLM
 Date
 Stamp

| | | | | | | |
|----|--|--|--|--|--|--|
| 7 | | | | | | |
| 8 | | | | | | |
| 9 | | | | | | |
| 10 | | | | | | |

6. That between the dates starting at 12 o'clock noon on September 1, 20 14 and ending at 12 o'clock noon on September 1, 20 15 at least \$ 230.00 dollars worth of work and improvements were done and performed upon said claim(s) or upon one or more of a contiguous group of claims for the benefit of all, wholly or partly outside of a contiguous group of claims for the benefit of all, not including the location work.

7. That the following persons were employed to perform the work and improvements described herein: Ben Apple - Laborer and myself Michael Ciunmo

8. That the work and improvements performed were: Road improvements from heavy rains and filling in holes from metal detectors and picking campers trash from the Buried Dreams claim

9. Dated: 8-19-14 Signature: Michael Ciunmo

SUBSCRIBED AND SWORN TO before me, a Notary Public, this 19 day of August 20 14

By: Michael Ciunmo

Notary Public [Signature]

My Commission Expires 8/01/2018

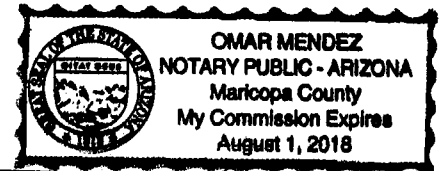

Bureau of Land Management
 Arizona State Office
www.az.blm.gov

No. of Claims: 1 x \$10 = 10
 Check No.: CC Init. MC
 Receipt No.: 3106014
 For BLM Use Only

United States Department of the Interior
Bureau of Land Management
 LANDS/RECREATION & PLANNING
 ONE N CENTRAL AVE
 PHOENIX, AZ 85004 -2203
 Phone: 602-417-9200



Receipt

No: 3106014

| | |
|--|--|
| Transaction #: 3197663 | |
| Date of Transaction: 08/19/2014 | |
| CUSTOMER: | |
| MICHAEL CIUMMO 11433 E JUAN TABO RD SCOTTSDALE, AZ 85255-5706 US | |

| LINE # | QTY | DESCRIPTION | REMARKS | UNIT PRICE | TOTAL |
|---------------|------|---|----------------|------------|----------------|
| 1 | 1.00 | LOCATABLE MINERALS / MINING CLAIMS- NOT NEW-UNADJUD, ONE AUTH NO. ONLY / MINING CLAIM MONEY RECEIVED CASES: AMC427442/\$10.00 | POL 2014/1 WAV | - n/a - | 10.00 |
| TOTAL: | | | | | \$10.00 |

| PAYMENT INFORMATION | | | |
|---|---------------|--|----------------------|
| NOTE: Items will appear on credit card statement as "Bureau of Land Mgmt CO". | | | |
| 1 | AMOUNT: | 10.00 | POSTMARKED: N/A |
| | TYPE: | CREDIT CARD | RECEIVED: 08/19/2014 |
| | NAME: | CIUMMO, MICHAEL 11433 E JUAN TABO RD SCOTTSDALE AZ 85255-5706 US | |
| | CARD NO: | XXXXXXXXXXXX7450 | AUTH CODE: 162493 |
| | NAME ON CARD: | MICHAEL G CIUMMO | |
| | EXPIRES: | 07/2018 | |
| | SIGNATURE: | | |

| |
|---------|
| REMARKS |
| |

This receipt was generated by the automated BLM Collections and Billing System and is a paper representation of a portion of the official electronic record contained therein.

UNITED STATES
 DEPARTMENT OF THE INTERIOR
 BUREAU OF LAND MANAGEMENT
**MAINTENANCE FEE PAYMENT FORM
 FOR PLACER MINING CLAIMS**

AMC 427442

Remitter Name: Jimmie Cope
 Mailing Address: 3716 W Monona Drive
 City, State, Zip: Glendale Az 85308

Check here if this is a change of address.

FOR COUNTY RECORDER'S USE

No. of claims 1
 Total due BLM \$ 15.00

- The maintenance fee may be paid by cash, check, money order, Bureau of Land Management (BLM) Declining Deposit Account, or credit card (VISA, American Express, Discover, or MasterCard). Payments must be remitted to the BLM State Office where your claim or site is recorded and received on or before September 1. If the payment is mailed, the envelope must be postmarked by a bona fide delivery service on or before September 1 and received at the proper BLM State Office within 15 calendar days after the due date. Payments may also be made by telephone using a credit card. A complete listing of BLM State Offices with their addresses and phone numbers can be found at <http://www.blm.gov>.
- The maintenance fee for the following claim(s) applies to the assessment year 2014.

| CLAIM NAME | BLM SERIAL NO. | ACRES IN CLAIM | PAYMENT DUE TO THE BLM (See Instructions on Page 2) |
|---------------|----------------|----------------|--|
| buried dreams | AMC427442 | 20 | 15.00 |
| | | | |
| | | | |
| | | | |
| | | | |
| | | | |
| | | | |
| | | | |
| | | | |

RECEIVED
 BLM AZ STATE OFFICE
 PHOENIX, ARIZONA
 2014 JUL 10 P 1:43

Use a separate sheet for additional claim names, serial numbers, and claimant names and addresses.

3074571

United States Department of the Interior
Bureau of Land Management
 LANDS/RECREATION & PLANNING
 ONE N CENTRAL AVE
 PHOENIX, AZ 85004 -2203
 Phone: 602-417-9200

Receipt

No: 3074571

| | |
|---|--|
| Transaction #: 3165747 | |
| Date of Transaction: 07/10/2014 | |
| CUSTOMER: | |
| JIMMIE COPE 3716 W MONONA DR GLENDALE, AZ 85308-2128 US | |

| LINE # | QTY | DESCRIPTION | REMARKS | UNIT PRICE | TOTAL |
|---------------|------|--|-----------------|------------|----------------|
| 1 | 1.00 | LOCATABLE MINERALS / MINING CLAIMS- NOT NEW-UNADJUD, ONE AUTH NO. ONLY / MINING CLAIM MONEY RECEIVED CASES: AMC427442/\$15.00 | ADDITIONAL FEES | - n/a - | 15.00 |
| TOTAL: | | | | | \$15.00 |

| PAYMENT INFORMATION | | | |
|---|---------------|---|----------------------|
| NOTE: Items will appear on credit card statement as "Bureau of Land Mgmt CO". | | | |
| 1 | AMOUNT: | 15.00 | POSTMARKED: N/A |
| | TYPE: | CREDIT CARD | RECEIVED: 07/10/2014 |
| | NAME: | COPE, JIMMIE 3716 W MONONA DR GLENDALE AZ 85308-2128 US | |
| | CARD NO: | XXXXXXXXXXXX6442 | AUTH CODE: 759472 |
| | NAME ON CARD: | JIMMIE COPE | |
| | EXPIRES: | 01/2016 | |
| | SIGNATURE: | | |

| |
|---------|
| REMARKS |
| |

This receipt was generated by the automated BLM Collections and Billing System and is a paper representation of a portion of the official electronic record contained therein.

*#15 Refunded.
AT*

Mr. Cope,

8/11/2014

On July 10, 2014, our office received a \$15 payment from you for additional fees. Is this payment for the \$15 increase on the 2015 Maintenance Fees for mining claims? We currently show that you located a new claim, AMC427442 Buried Dreams, in March 2014. The fees paid when you located that claim included the 2014 Maintenance Fee. The 2015 Maintenance Fee is due by September 1, 2014. Our records do not indicate that you've paid the 2015 Maintenance Fee payment. You will need to pay \$140 for the 2015 Maintenance Fee. We will then process the \$15 additional payment which will bring your account up to date for the 2015 Maintenance Fee due totaling \$155.

You may call the public room at 602-417-9200 to make a payment by credit card or you may mail it to:

Bureau of Land Management
One North Central Ave STE 800
Phoenix, AZ 85004-4427

Please make sure you have your AMC number and claim name available. They are AMC427442 Buried Dreams. If you call in with the payment, let the person know that you've previously paid the \$15 additional portion and only need to pay the \$140 to bring you up to date on your maintenance fee.

If you have any questions, don't hesitate to call me.

Thank you,

RéAnn Myers
Land Law Examiner
Bureau of Land Management
Arizona State Office
602-417-9413

NOTICE!!

These documents have been scanned!

Do not place un-scanned documents beneath this notice!

Do not remove this notice from this file!

GPO Jacket No. 560-102
Print Order 61540
Rise Business Services, LLC
Job=AZ15 6/24/2019



Box Number= AZ15129



Claim Begin-End: AMC427442-AMC427442

5 Miscellaneous



AZ15129-12

AMC364820-AMC427442

**NO
DOCUMENTS
FOUND**

NO DOCUMENTS FOUND
NO DOCUMENTS FOUND

NOTICE!!

These documents have been scanned!

Do not place un-scanned documents beneath this notice!

Do not remove this notice from this file!

GPO Jacket No. 560-102
Print Order 61540
Rise Business Services, LLC
Job=AZ15 6/24/2019



Box Number= AZ15129



Claim Begin-End: AMC427442-AMC427442

6 Location Notices-Amendments and Supporting Documents

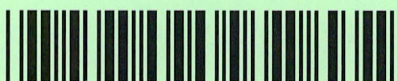

AZ15129-12

AMC364820-AMC427442

MINING CLAIM STATUS REPORT

Data Entered: 03/12/14 RAM

MTP Checked By: AME
GEO Checked By: AME

LEAD SERIAL NUMBER: AMC 427442 thru AMC _____

NUMBER OF CLAIMS & TYPE:

LODE _____
PLACER 1 _____
ASSOCIATION PLACER _____
MILL SITE _____
TUNNEL SITE _____

CHARGES:

Location Fee @ \$34 = \$ 34
Processing Fee @ \$20 = \$ 20
Maintenance Fee @ \$140 = \$ 140
Add'l Maint Fee for Assoc Placer = \$ _____
SUBTOTAL \$ _____
Other Fees \$ _____
Other Fees \$ _____
TOTAL \$ 194

TOTAL ACREAGE: _____ Per Claim
(Placer Only)

NUMBER OF LOCATORS: _____

DOCUMENTS RECEIVED VIA: Over-the-Counter Mail TIMELY FILED: Yes No

LEGAL DESCRIPTION: T 11N R 1E SEC 26
T _____ R _____ SEC _____
T _____ R _____ SEC _____
T _____ R _____ SEC _____
T _____ R _____ SEC _____

BLM FOREST SERVICE Prescott SUBJ TO PL 359: Yes No
WILDERNESS AREA

SPLIT ESTATE: N/A SX PX OTHER
SRHA Was proper Notice filed if located on SHRA Land? Yes No

RECONVEYED MINERALS ON BLM LAND REQUIRE OPENING ORDER FROM 1944 TO 1993:

Open to Entry On _____ N/A

COMMENTS/STATUS: VOID PARTIALLY VOID PVT MINERALS WITHDRAWN LANDS
OTHER

Claimant acknowledges that portions of the following claim(s) site(s) may be void or voidable.

Printed Name of Claimant _____ Signature of Claimant _____

*****FINAL ADJUDICATION*****

DATE 6/26/14 INITIALS AT

AMC 427442

LOCATION NOTICE FOR PLACER MINING CLAIM

NOTICE IS HEREBY GIVEN that the Buried Dreams
_____ placer mining claim has been located by
Jimmie Cope JR whose current mailing
address is 3716 West Manana DRIVE
Glendale AZ 85308

| | |
|----------------------|---------------------|
| BLM Date Stamp | RECEIVED |
| | BLM AZ STATE OFFICE |
| | 2014 MAR -4 A 9:13 |
| | PHOENIX, ARIZONA |

The general course of this claim is Westerly and it is situated in
Yavapai County, Arizona.

This claim is 1320 feet in length and 660 feet in width. This claim runs from the
location monument on which this location notice is posted approximately 1320 feet in a Westerly
direction to the NW end line and 660 feet in a Southerly direction to the SW end line.
This claim is marked by four monuments, one at each corner of the claim.

The location monument on which this notice is posted is situated within Section 26, Township
11 North, Range 1 East, Gila Salt River Base and Meridian, Arizona. This claim encompasses
portions of the following legal subdivision(s) if located by legal subdivision or the following quarter section (s),
section (s), Township (s) and Range (s) SE 1/4 T11 R 1E

_____, Gila Salt River Base and Meridian, Arizona.

The locality of this claim with reference to some natural object or permanent monument and additional
information (if any) concerning its locality are as follows: _____

DATED AND POSTED on the ground this 1st day of March, 2014.

LOCATOR (s) Jimmie Cope JR

Form MCF102
Revised July 2005

AM04274421

MINING CLAIM MAP

Lode () Placer (X)

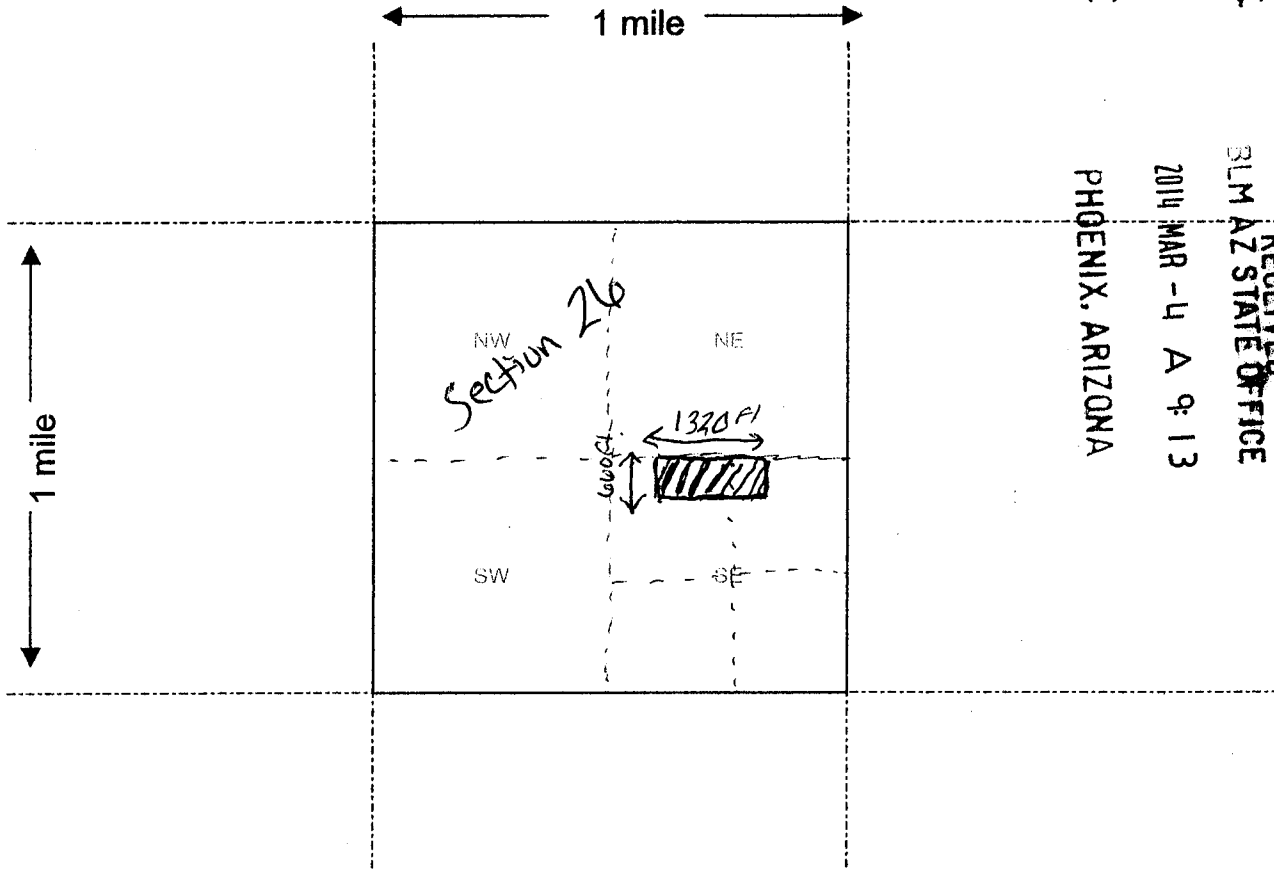

RECEIVED
BLM AZ STATE OFFICE
2014 MAR -4 A 9:13
PHOENIX, ARIZONA

AM04274421

Scale : 1" = 2000 feet



1. The above map depicts the Buried Dreams mining claim, which is located in Section (s) 26, Township 11 North, Range 1 East, Gila and Salt River Base and Meridian, _____ County, Arizona.
2. The type of corner and location monuments used are as follows: 2x2 white PVC corner markers
3. The bearings and distances in degrees and feet between claim corners are as depicted on the map.

Form MCF100a
Revised July 2005

RUN TIME: 09:12 AM

RUN DATE: 03/04/2014
Page 1 of 1

DEPARTMENT OF INTERIOR
BUREAU OF LAND MANAGEMENT

Input Parameters for Geographic Report with Land

System Id = CR

Admin State = AZ

Geo State =

Casetype Begins With

Case Disp Txt = AUTHORIZED, CANCELLED, EXPIRED, PENDING, REJECTED, RELINQUISHED, VOID, WITHDRAWN

Mer Twp Rng =

Section =

Mtrs = 14 0110N 0010E 026, 14 0110N 0010E 999

Commodity =

Commodity Txt =

Pending Org =

Pend Org Decode =

Total Rows Returned: 0

NO WARRANTY IS MADE BY BLM FOR USE OF THE DATA
FOR PURPOSES NOT INTENDED BY BLM

SURVEYED TOWNSHIP 11 NORTH RANGE 1 EAST OF THE GILA AND SALT RIVER MERIDIAN, ARIZONA

PROTRACTION DIAGRAM NO 16 OFFICIALLY FILED 12/07/1959

YAVAPAI COUNTY
HASSAYAMPA FIELD OFFICE

STATUS OF PUBLIC DOMAIN
LAND AND MINERAL TITLES

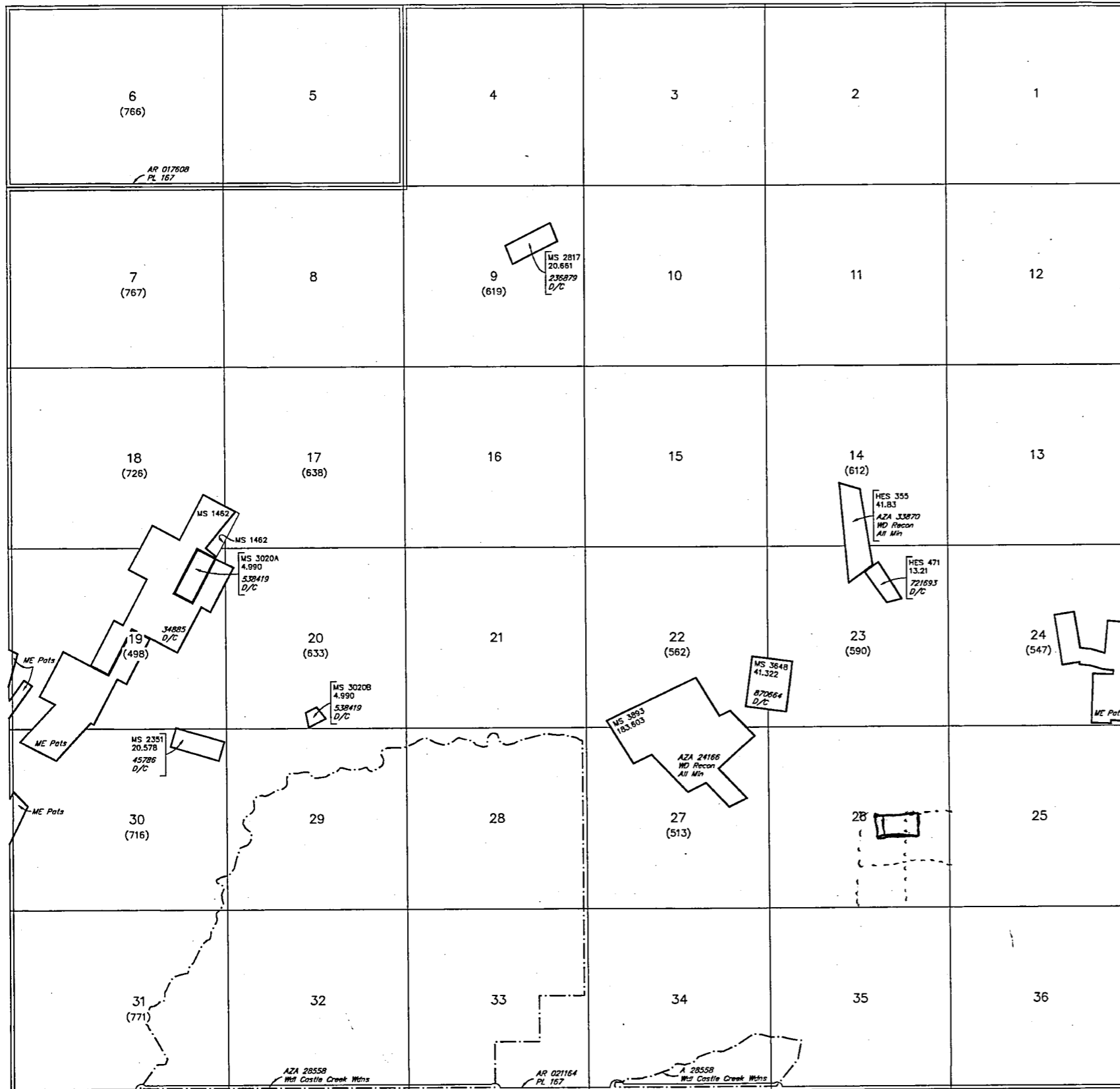

| INDEX TO SEGREGATED TRACTS | | | | |
|----------------------------|-----------------|---|-----|-------------|
| RESURVEY TRACT NO | ORIGINAL SURVEY | | | |
| | T | R | SEC | SUBDIVISION |
| | | | | |
| | | | | |
| | | | | |
| | | | | |
| | | | | |
| | | | | |
| | | | | |
| | | | | |
| | | | | |
| | | | | |

FOR ORDERS AFFECTING DISPOSAL OR USE OF UNIDENTIFIED LANDS WITHDRAWN FOR CLASSIFICATION, MINERALS, WATER AND/OR OTHER PUBLIC PURPOSES, REFER TO INDEX OF MISCELLANEOUS DOCUMENTS.

MDS 9 NW
10 SW
11 SE

All Tp included in Wdl Prescott NF Proc 10/21/1899

PHX 085401 R/W Transmission Line 100'
Sec 1: E1/2

T 11N R 2E
T 10N

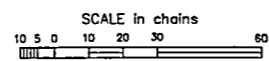

WARNING STATEMENT
This plot is the Bureau's Record of Title, and should be used only as a graphic display of the township survey data. Records hereon do not reflect title changes which may have been effected by lateral movements of rivers or other bodies of water. Refer to the cadastral surveys for official survey information.

| CURRENT TO | NW | GSR Mer |
|------------|------|---------|
| 2-25-2013 | ACAD | T 11 N |
| | | R 1 E |